



ISEO[®]

**Whatever situation it
would be,
no panic,
only with Best Idea.■**

The Antipanic Compliance to the standard EN1125

Panic device compliant to EN1125, ISEO is offering a complete range of user-friendly panic exit device with horizontal and vertical locking for doors in emergency escape routes in which safety and reliability of the product is very essential. ISEO Idea range of products cover in full requirements that ideally to be install in public facilities such as universities, schools, lecture halls, performing stadium, hospitals, air-ports, shopping malls, subway stations and train stations.

Where as those areas / buildings where there is generally no public pedestrian and low traffic usage, Idea Pad and Pad-Bolt provides which complied to EN179 standards, the ideal solution for this application. Emergency escape exit in accordance with EN179, the product is used in buildings with no public pedestrian traffic, people are using the devices for escape purpose are expected to be familiar with the exits and operation of this devices, whereby panic situation are unlikely to happen with small crowd. All ISEO Idea pad and pad-bolt are tested and certified compliant with EN179 and therefore bearing the CE mark of conformity.

For both Emergency Panic exit (such as base, base-bolt, push, push-bolt, push-latch) and escape exit products. Pad and pad-bolt are using the same external fittings, Trim - one fitting for universal application.



How to read the marking EN 1125:2008



Not suitable for use on fire/smoke doors

Suitable for use on fire/smoke doors

	3	7	6	0	1	4	2	2	A	A
	3	7	6	B	1	4	2	2	A	A
Category of use										
Durability										
Door mass										
Suitability for use on fire/smoke resistant doors										
People's safety										
Corrosion resistance										
Goods' security										
Bar projection										
Type of bar operation										
Field of door application										

Category of use. There is only one category which refers to a high frequency of use where there is little incentive to exercise care, i. e. where there is a chance of an accident and misuse.

Durability. There are two grades of durability:
 grade 6 = 100,000 operations
 grade 7 = 200,000 operations

Door mass. There are three door mass categories:
 grade 5 = up to 100 kg
 grade 6 = up to 200 kg
 grade 7 = over 200 kg

Suitability for use on fire/smoke resistant doors. There are three fire/smoke resistance categories:
 grade 0 = not suitable for fire/smoke resistant doors
 grade A = suitable for smoke resistant doors
 grade B = suitable for fire/smoke resistant doors

People's safety. There is only one category representing the maximum grade, since panic exit devices must ensure people's safety.

Corrosion resistance. There are two categories as per prEN1670:
 grade 3 = 96 h (high resistance)
 grade 4 = 240 h (very high resistance)

Security. Only one grade of security shall be used: the security requirements are secondary to those of safety.

Bar projection. There are two categories:
 grade 1 = bar projection up to mm 150 (large projection)
 grade 2 = bar projection up to mm 100 (standard projection)

Type of bar operation. There are two types of operations:
 A = panic exit device with "push-bar" operation (Idea)
 B = panic exit device with "touch-bar" operation (Push-Bar)

Field of door application. There are three categories:
 A = single door, double door: active or inactive leaf
 B = single door only
 C = double door, inactive leaf only.

IDEA.



ISEO®

Height 2400/2270mm

Total width 1285mm

Rod-covered

Side latch

to eliminate the difficulties in installation due to flooring.

Immediate reversibility

Change the arm by a simple click direction.

Fixing of the rods by simple click

fast and convenient with a great adjustment

Pre-installation in fabrication factories

to facilitate faster & efficient installation on the building site



Optional items:- _____

- Kit for extension of up to 3400mm (H)
- Dogging device
- Possible integration with a microswitch for various applications.
- Adjustable upper keep for Base-bolt. 94300163



Design

Contemporary, three colours (white, grey, black),
narrow profile 37mm allowing the installation on any
form of doors (aluminium, wooden, steel, PVC)

Ergonomics

Shock-proof shape, round edges and
with fingers-grip.

Reversibility





Immediately reversibility and easy installation.

Guarantee 10 years









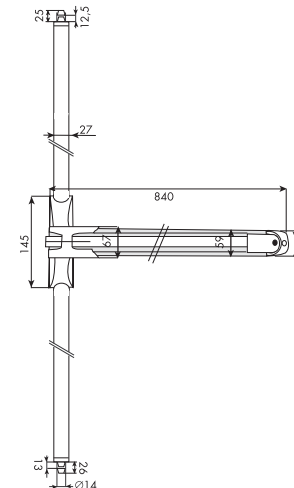
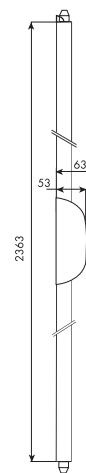

**Push &
Push-bolt**



Code Finish: painted
 9452084444A white  
 9452084334A grey  



Code Finish: painted
 942108458TA red/black  
 942108444TA white  
 942108433TA grey  
 942411733T grey  

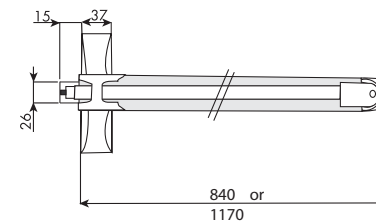

OPTIONAL ⇔
 Adjustable upper keep
 (Can be adjustable up
 to 23mm)
 Code : 94300163

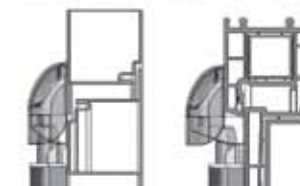

**Push &
Push-latch**



Code Finish: painted
 942208458TA ■ ■ red/black
 942208444TA white
 942208433TA grey

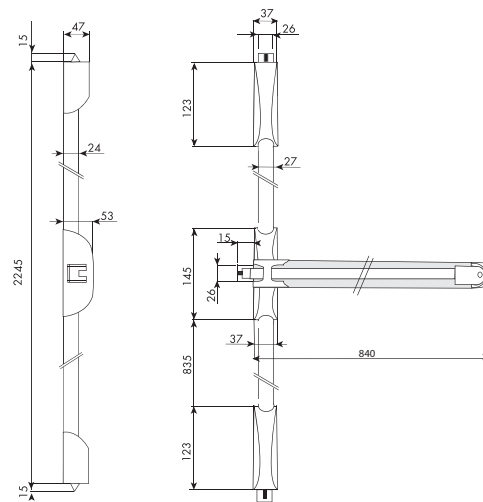

Code Finish: painted
 942108458TA ■ ■ red/black
 942108444TA white
 942108433TA grey
 942411733T grey

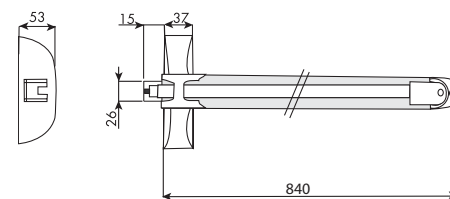

Pad & Pad bolt

94300163
Adjustable keep
* Optional to be ordered separately

Strike plate

94100040
Pre - installation template
to be ordered separately

Dust cover
to be ordered separately.

Pad bolt

Emergency exit device tested and approved to EN179, non-handed. Can be unlocked electrically via electric strike. All products of the Pad series carry the CE mark of conformity.

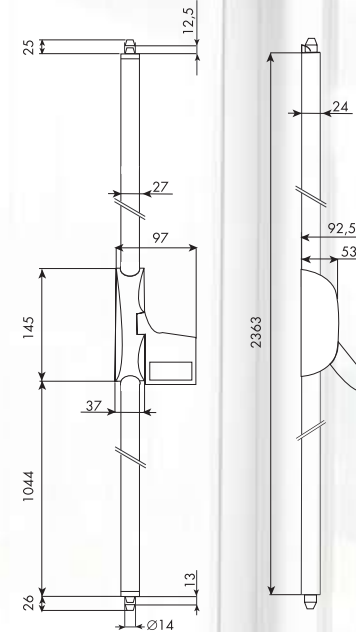

Pad



- Grey Code : 9461000305
- White Code : 9461000405
- Black Code : 9461000504

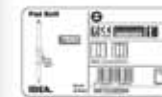

d = 1190 x 180 x 85 mm

			Code
	Grey	2 points pad bolt	9472020304
	White	2 points pad bolt	9472020404
	Black	2 points pad bolt	9472020504

**Push-Bar
PVD**



- Anti-thrust latch
- Reversible

Code : 9410201524 INOX

Grey 94402033T

White 94402044T

Black 94402055T



Code : 94100202 INOX

Grey 94402003

White 94402004

Black 94402005

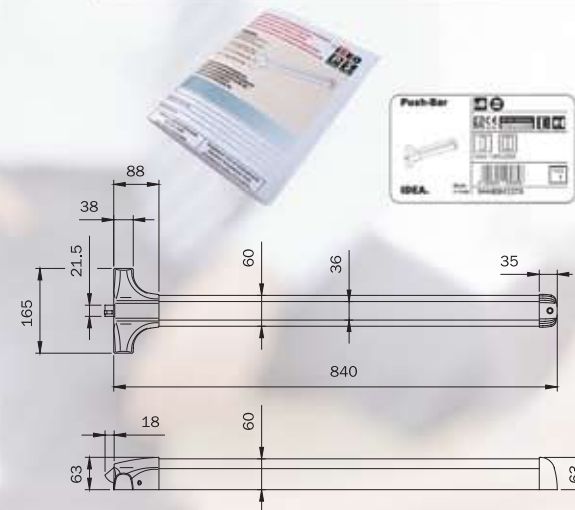

			Code	
Grey	<input type="checkbox"/>	1 point push	944408433TA	
White	<input type="checkbox"/>	1 point push	944408444TA	
Black	<input type="checkbox"/>	1 point push	944408455TA	

**Base-Inox with
Belvedere**

Assembly kit for glass doors

Innovation

Assembly kit for antipanic glass doors

without frame

(Base, Push, Push-Bolt, Pad and Pad-Bolt)

1 point, 2 points, 3 points high and low.

3 points side and together of external operation.

Design and safety

The most advanced design with the Largest protection

Colour

Completion nickel gloss.

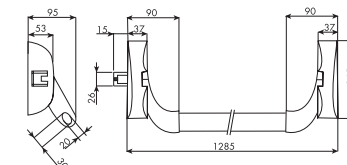

Base-Inox Code : 9414113224

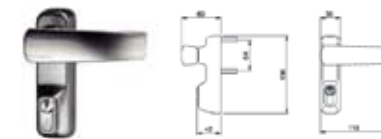

Trim-Inox Code : 94011002T

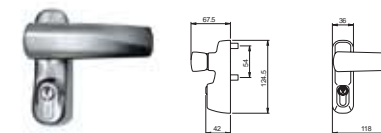

Trim-Inox

Belvedere Series Code : 94011002T



IDEA.

Belvedere

Assembly kit for glass doors

ISEO[®]



www.iseo.eu



For central lock assembly with "BASE" and "BOLT", without external control
Code : 94100506



For central lock assembly with "PUSH" and "PUSH BOLT", with external control
Code : 94100546



For pair of vertical rods "BOLT"
Code : 94100586



For central lock assembly with "BASE" and "BOLT", with external control
Code : 94100516



For central lock assembly with "PUSH" and "PUSH BOLT", with external control
Code : 94100556



For lateral keep and top vertical keep
Code : 94100596



For central lock assembly with "BASE" and "BOLT", with external control
Code : 94100526



For pairs of vertical latches "BASE"
Code : 94100566



For adjustable top keep for panic exit devices "BOLT"
Code : 94100606



For central lock assembly with "PUSH" and "PUSH BOLT", without external control
Code : 94100536



For pairs of vertical latches "BASE"
Code : 94100576



Kit of rod covering profiles
Code : 94100616